

HK4520-AS1-B

Drawn cup needle roller bearing open end

Schaeffler ID:
0041120400000

Drawn cup needle roller bearing open end
HK...AS1-B, single row, with cage

Technical information

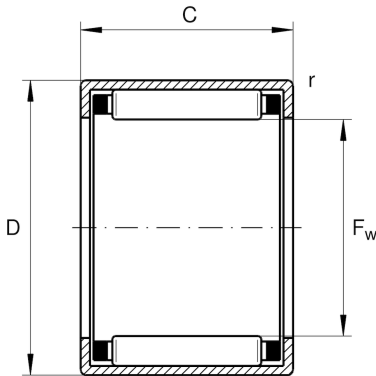

Main Dimensions & Performance Data

F_w	45 mm	Under roller diameter
D	52 mm	Outside diameter
C	20 mm	Width
C_r	27.000 N	Basic dynamic load rating, radial
C_{0r}	59.000 N	Basic static load rating, radial
C_{ur}	7.700 N	Fatigue load limit, radial
n_G	5.900 1/min	Limiting speed
$n_{G \text{ Grease}}$	3.550 1/min	Limiting speed for grease lubrication
n_{gr}	4.450 1/min	Reference speed
	55,2 g	Weight

Dimensions

C_1	20 mm	Width, outer ring
r_{\min}	0,8 mm	Minimum chamfer dimension

Temperature range

T_{\min}	-30 °C	Operating temperature min.
T_{\max}	140 °C	Operating temperature max.

Additional information

SD45X52X4	Sealing ring
G45X52X4	Sealing ring 2
LR40X45X20,5	Suitable inner rings LR
IR40X45X20-XL	Suitable inner rings IR